

Recommended P.C. Board Hole Layout

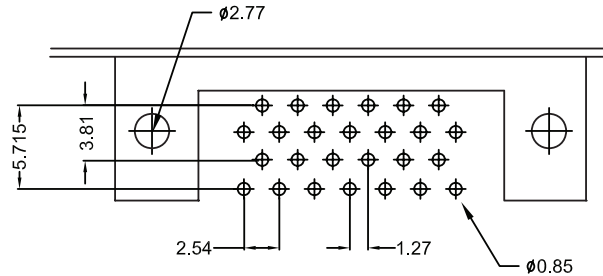

Specifications

- Current Rating: 1 Amp
- Operating Temp.: -55°C ~ +105°C
- Dielectric Strength : 500V AC/min
- Insulation Resistance: 500MΩ Min. at 500VDC
- Contact Resistance: 35 million ohms Max.
- Insulator Material: PBT+30% Glass Fiber (UL94V-0)
- Contact: Brass
- Contact Plated: Under Plating : Nickel 50u" Plated
Over Plating : Gold Flash Plated
- Shell: Steel, Nickel Plated
- Board Lock : Brass , Tin Plated

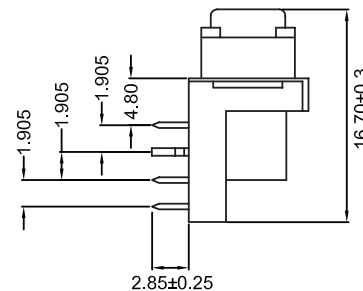
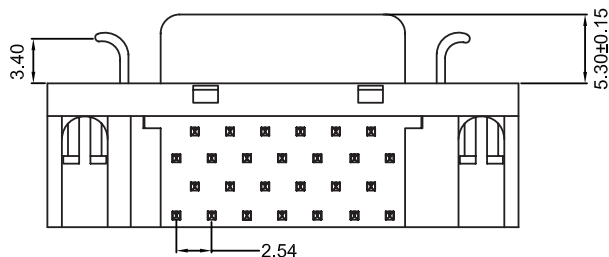

Part Numbering System

DU03 - 26 F S X X X X

- Series:** DU03
- Contact Number:** 26
- Contact Type:** F = Female
- * Contact Plating:**
 - S = Selective Gold Flash : Tin Plated on Solder Area
 - Gold Flash on Contact Area
- Shell Plating:** N = Nickel (Standard)
- Insulator Color:** 3 = Black
- Threaded Option:**
 - 1 = # 2-56
 - 2 = # 4-40
 - 3 = M2.6
- Process Option:** B = Board Fork Lock

General Tolerance	
X. ± 0.50	X.° ± 5°
.X ± 0.20	.X° ± 2°
.XX ± 0.10	.XX° ± 1°
Units : mm	