

### Recommended P.C. Board Hole Layout

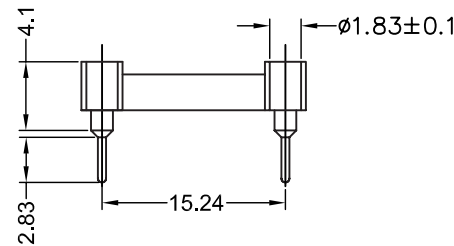
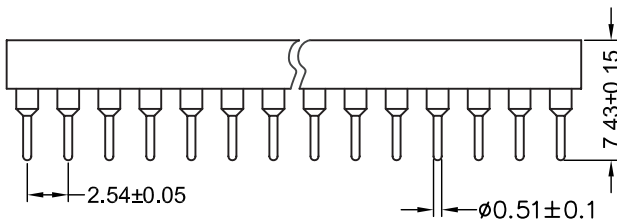
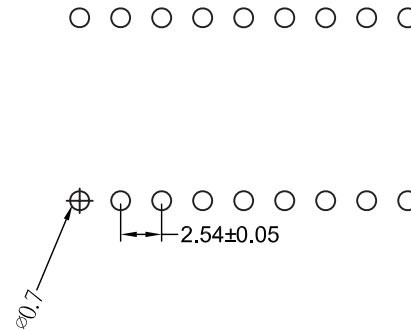

Contacts	Dimension mm		Type	Contacts	Dimension mm		Type
	A	B			A	B	
24	27.84	30.48	Without Bar	24	27.84	30.48	With Bar
28	33.02	35.56		28	33.02	35.56	
32	38.10	40.64		32	38.10	40.64	
42	48.26	50.80		36	43.18	45.72	
				40	48.26	50.80	
				42	50.80	53.34	
				48	58.42	60.96	

General Tolerance	
X. ± 0.50	X.° ± 5°
.X ± 0.20	.X° ± 2°
.XX ± 0.10	.XX° ± 1°
Units : mm	

## Specifications

Contact Rating: 3A / Contact max.  
Contact Resistance: ≤4mΩ max.  
Insulation Resistance: ≥ 1000MΩ at V = 100V  
Operating Voltage: 60 VAC / DC

Pin (outer sleeve): Brass, machined CuZn38Pb2  
Pin Plating: Tin Plated: 2um/80μ" Ni, 5 um/200μ" Sn or Gold Plated  
Clip (contact 4 finger): Beryllium Copper, Phosphor Brozen heat treated  
Clip Plating: Gold Plated: 2um/80μ" Ni, Full Gold  
Insulator (black): Glass filled UL94V-0

Average insertion force with steel pin of ø0.43mm/0.17": >250g min.  
Average withdrawal force with steel pin of ø0.43mm/0.17": >50g min.  
Mechanical life cycle: 200 min.  
Acceptable pin diameter range: ø0.45 - 0.60mm

Operating Temperatures:  
Gold Plated: -55°C to +105°C  
Tin Plated: -40°C to +105°C  
Soldering Temperature: +240°C, 10s max.

## Part Numbering System

