

Recommended
P.C. Board Hole Layout

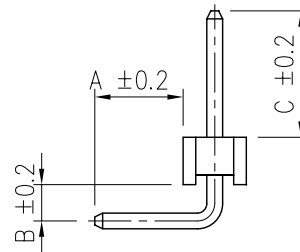
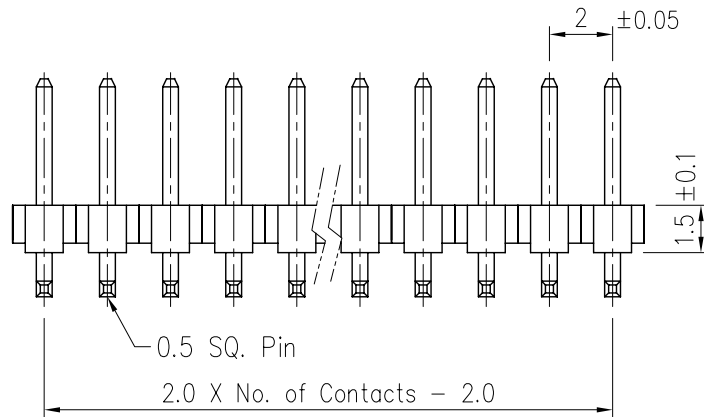
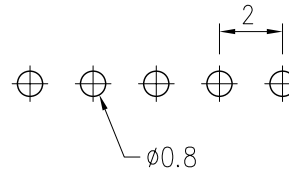

Specifications

- Current Rating: 2 Amp
- Insulator Resistance: 1000 Megohms min.
- Contact Resistance: 20 m ohms max.
- Dielectric Withstanding: AC 500V
- Operating Temperature : -40°C ~ +105°C
- Insulator Material: Polyester, UL 94V-0, Nylon-6T
- Contact Material: Brass
- Contact Plating: Full Gold, Full Tin, Selective Plated

Part Numbering System

LS200-H1.5 - XX - A-B-C - X N

Series

No. of Pins

Terminal Dimensions Required

A = ... , B = ... , C = ...

Contact Plating

Insulator Material:
N = Nylon-6T

Example: LS200-H1.5-12-4.00-3.00-5.00-GN
with 12pins, A= 4.00, B= 3.00, C = 5.00

| * Contact Plating Option | Full Gold Plating | Gold Plated On Contact Area Tin Plated on Solder Area | Full Tin Plating |
|--------------------------|--|---|------------------|
| | G : Gold Flash G10: Gold 10u" G15: Gold 15u" G30: Gold 30u" | S: Gold Flash S10: Gold 10u" S15: Gold 15u" S30: Gold 30u" | T: Tin 100u" |

| General Tolerance | |
|-------------------|-----------|
| X. ± 0.50 | X.° ± 5° |
| .X ± 0.20 | .X° ± 2° |
| .XX ± 0.10 | .XX° ± 1° |
| Units : mm | |