

Recommended P.C. Board Hole Layout

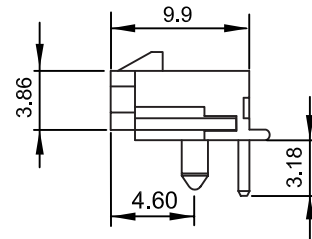
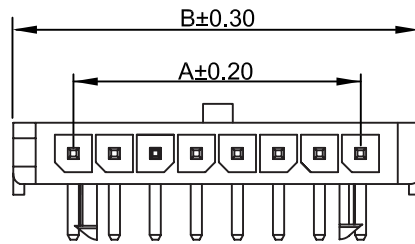
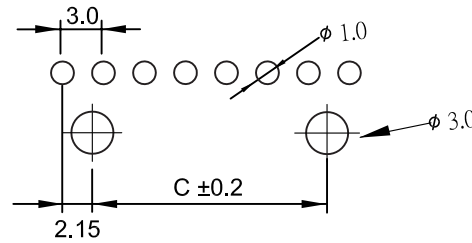
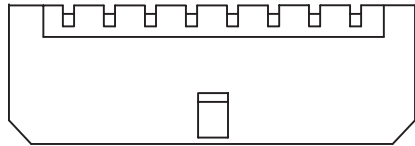

Specifications

Current Rating: 5 Amps Max
 Insulator Resistance: 1000 Megohms min.
 Contact Resistance: 20 m ohms max.
 Dielectric Withstanding: AC 600V
 Operating Temperature : -40°C ~ +105°C
 Insulator Material: Polyester, UL 94V-0 Nylon 46
 Contact Material: Brass
 Contact Plating: Tin Plated

Part Numbering System

MF300-RS - XX X - T

Series

No. Of Pins:

02~12

Post Option:

Nil = with Alignment Pin

W = w/o Alignment Pin

Contact Plating:

T = Tin

Contacts	Dimension mm		
	A	B	C
2	3.00	9.00	-
3	6.00	12.00	-
4	9.00	15.00	4.70
5	12.00	18.00	7.70
6	15.00	21.00	10.70
7	18.00	24.00	13.70
8	21.00	27.00	16.70
9	24.00	30.00	19.70
10	27.00	33.00	22.70
11	30.00	36.00	25.70
12	33.00	39.00	28.70

General Tolerance	
X. ± 0.50	X.° ± 5°
.X ± 0.20	.X° ± 2°
.XX ± 0.10	.XX° ± 1°
Units : mm	

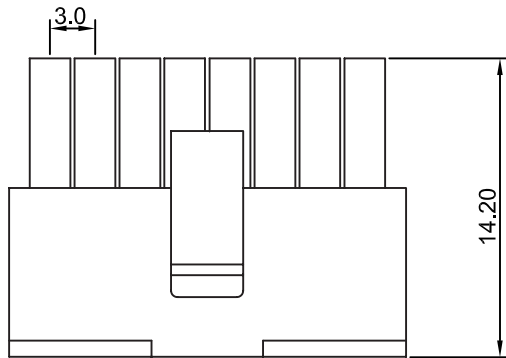
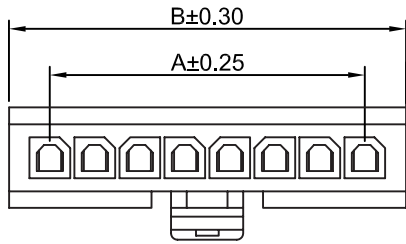

03pin ~ 12pin

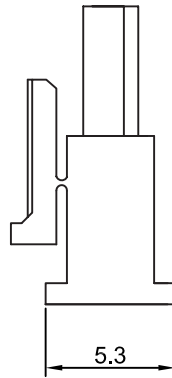

02pin

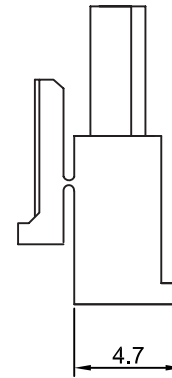

Specifications

Current Rating: 5A AC, DC
 Voltage Rating: 250V AC, DC
 Insulation Resistance: 1000MΩ Min.
 Operating Temp.: -25°C ~ +85°C
 Withstand Voltage: 1500V AC / minute

Part Numbering System

MF300HM-SS - XX

Series

No. Of Pins:

02~12

Pins	Dimensions	
	A	B
02	3.00	6.85
03	6.00	9.85
04	9.00	12.85
05	12.00	15.85
06	15.00	18.85
07	18.00	21.85
08	21.00	24.95
09	24.00	27.95
10	27.00	30.95
11	30.00	33.95
12	33.00	36.95

General Tolerance	
X. ± 0.50	X.° ± 5°
.X ± 0.20	.X° ± 2°
.XX ± 0.10	.XX° ± 1°
Units : mm	

MF300TF Series

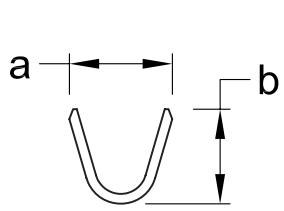

SEC. A-A

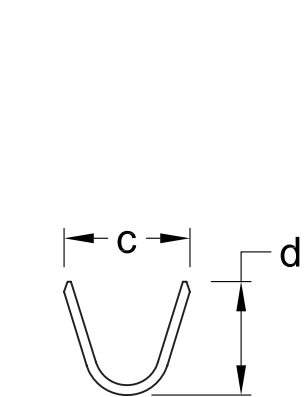
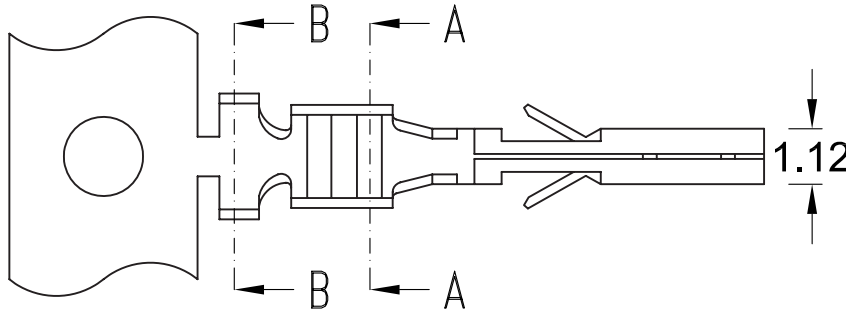

SEC. B-B

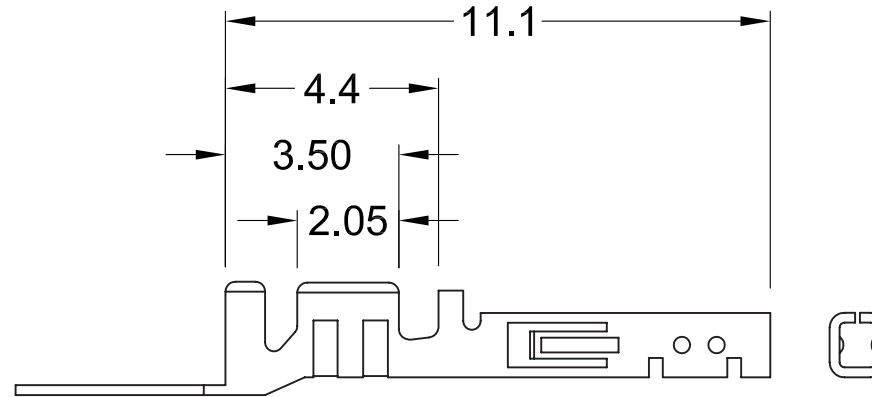

Wire Size	Dim. a	Dim. b	Dim. c	Dim. d
#20~#24 AWG	2.1	2.1	2.7	2.5
#26~#30 AWG	1.8	1.6	2.4	1.9

Specifications

Voltage Rating: 250V AC, DC
 Contact Resistance: 10m Max.
 Dielectric Strength: 1500V AC / minute
 Material: Phosphor Bronze
 Wire Range: AWG #20~#30
 Thickness: 0.2mm
 Temperature Rise: 30°C Max.
 Qty: 10,000pcs per Reel

Wire Size (AWG)	#20	#22	#24	#26	#28	#30
Current Rating (Amps)	5	5	4	3	2	1

Part Numbering System

MF300TF - X - XXXX

Series

Contact Plating:

T = Tin (Standard)
 S = Selective Gold Flash
 G = Full Gold Flash

Wire Size:

2024 = #20~#24 AWG
 2630 = #26~#30 AWG

General Tolerance	
X. ± 0.50	X.° ± 5°
.X ± 0.20	.X° ± 2°
.XX ± 0.10	.XX° ± 1°
Units : mm	

WAFER

MF300-RS - XX - XX

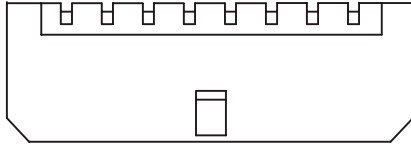

TERNIMAL / female
MF300TF - X - XX

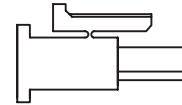

HOUSING/ male
MF300HM-SS - XX

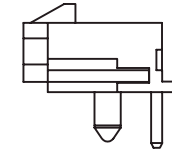

WAFER
MF300-RS - XX - XX

HOUSING/ male
MF300HM-SS - XX

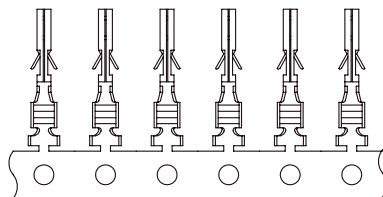
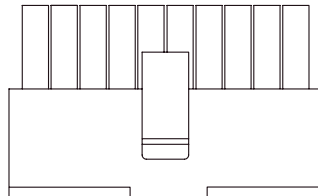

TERNIMAL / female
MF300TF - X - XX

General Tolerance	
X. ± 0.50	X.° ± 5°
.X ± 0.20	.X° ± 2°
.XX ± 0.10	.XX° ± 1°
Units : mm	