

Recommended P.C. Board Hole Layout

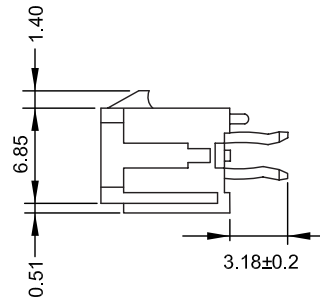
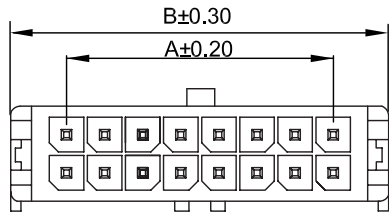
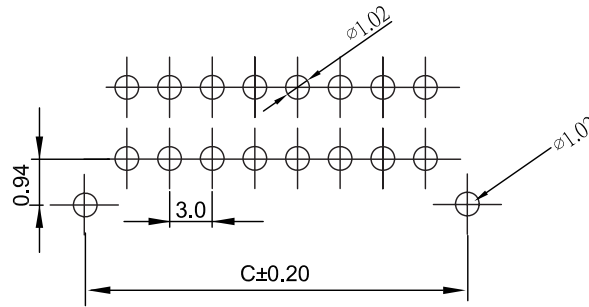
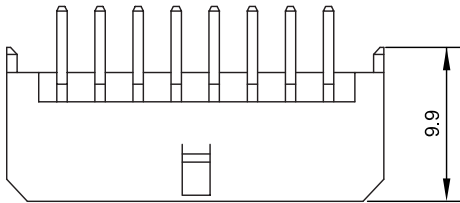

Pins	Dimensions		
	A	B	C
02	-	6.65	6.00
04	3.00	9.65	9.00
06	6.00	12.65	12.00
08	9.00	15.65	15.00
10	12.00	18.65	18.00
12	15.00	21.65	21.00
14	18.00	24.65	24.00
16	21.00	27.65	27.00
18	24.00	30.65	30.00
20	27.00	33.65	33.00
22	30.00	36.65	36.00
24	33.00	39.65	39.00

Specifications

Current Rating: 5 Amps Max
 Insulation Resistance: 1000M Ω Min.
 Contact Resistance: 10m Ω Max.
 Dielectric Withstanding: 1500V AC / Minute
 Operating Temp.: -40°C ~ +105°C
 Insulator: Polyester, UL 94V-0 Nylon 46
 Contact Material: Brass
 Contact Plating:
 Tin (Standard): Tin Plated 0.00010" (0.00254mm)
 over Nickel Plated 0.00005" (0.00127mm)
 Gold (Option): Gold Plated 0.00006" (0.00152mm)
 over Nickel Plated 0.00008" (0.00203mm)
 Packaging: Tray

Part Numbering System

MF300-SD - XX X - T

Series — MF300-SD
No. Of Pins: — XX
 02~24
Post Option: — X
 Nil = with Alignment Pin
 W = without Alignment Pin
Contact Plating: — T
 T = Tin (Standard)
 G = Gold Flash (Option)

General Tolerance	
X. ± 0.50	X.° $\pm 5^\circ$
.X ± 0.20	.X° $\pm 2^\circ$
.XX ± 0.10	.XX° $\pm 1^\circ$
Units : mm	

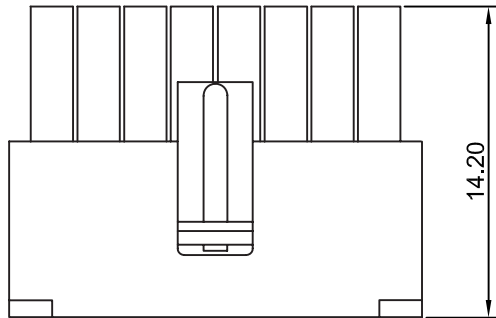
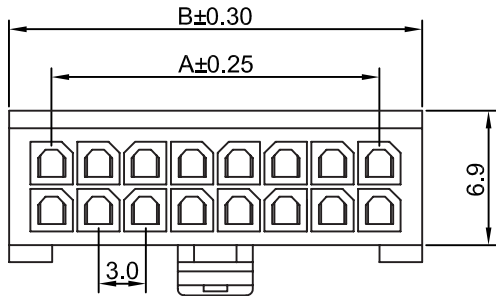

Pins	Dimensions	
	A	B
02	-	3.85
04	3.00	6.85
06	6.00	9.85
08	9.00	12.85
10	12.00	15.85
12	15.00	18.85
14	18.00	21.85
16	21.00	24.95
18	24.00	27.95
20	27.00	30.95
22	30.00	33.95
24	33.00	36.95

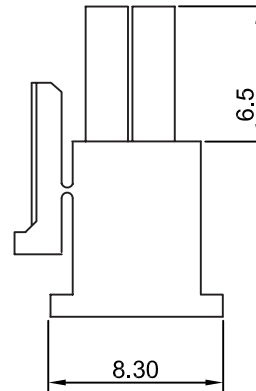

Specifications

Current Rating: 3A AC, DC
 Voltage Rating: 250V AC, DC
 Insulation Resistance: 1000MΩ Min.
 Operating Temp.: -25°C ~ +85°C
 Withstand Voltage: 1500V AC / minute

Part Numbering System

MF300HM-SD - XX

Series

No. Of Pins:

02~24

General Tolerance	
X. ± 0.50	X.° ± 5°
.X ± 0.20	.X° ± 2°
.XX ± 0.10	.XX° ± 1°
Units : mm	

MF300TF Series

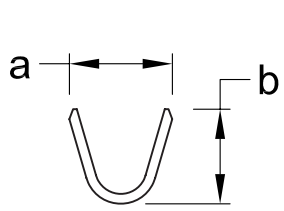

SEC. A-A

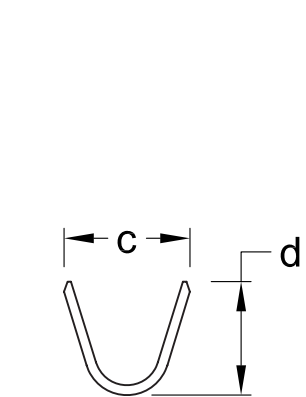
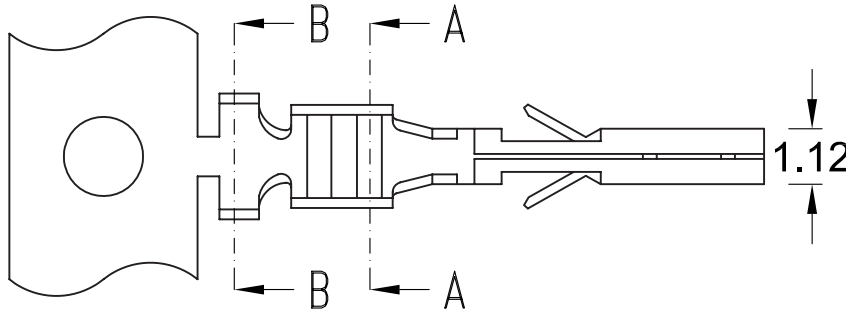

SEC. B-B

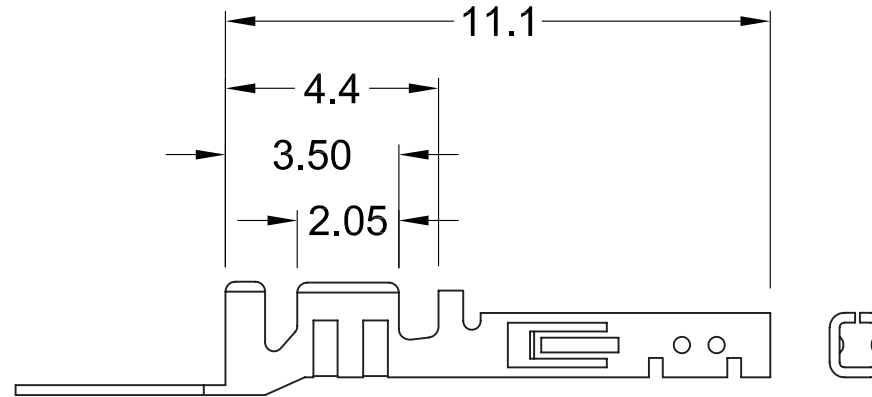

Wire Size	Dim. a	Dim. b	Dim. c	Dim. d
#20~#24 AWG	2.1	2.1	2.7	2.5
#26~#30 AWG	1.8	1.6	2.4	1.9

Specifications

Voltage Rating: 250V AC, DC
 Contact Resistance: 10m Max.
 Dielectric Strength: 1500V AC / minute
 Material: Phosphor Bronze
 Wire Range: AWG #20~#30
 Thickness: 0.2mm
 Temperature Rise: 30°C Max.
 Qty: 10,000pcs per Reel

Wire Size (AWG)	#20	#22	#24	#26	#28	#30
Current Rating (Amps)	5	5	4	3	2	1

Part Numbering System

MF300TF - X - XXXX

Series

Contact Plating:

T = Tin (Standard)
 S = Selective Gold Flash
 G = Full Gold Flash

Wire Size:

2024 = #20~#24 AWG
 2630 = #26~#30 AWG

General Tolerance	
X. ± 0.50	X.° ± 5°
.X ± 0.20	.X° ± 2°
.XX ± 0.10	.XX° ± 1°
Units : mm	

WAFER

MF300-SD - XX - XX

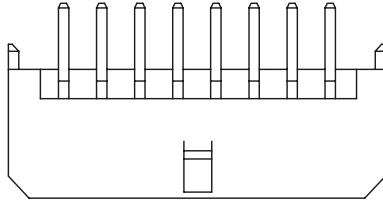

TERNIMAL / female
MF300TF - X - XX

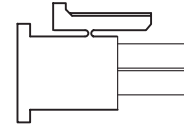

HOUSING/ male
MF300HM-SD - XX

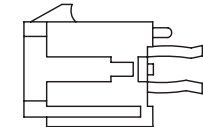

WAFER
MF300-SD - XX - XX

HOUSING/ male
MF300HM-SD - XX

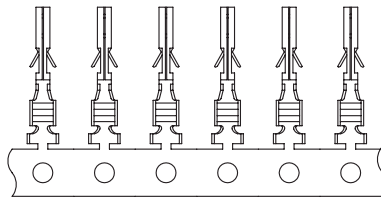
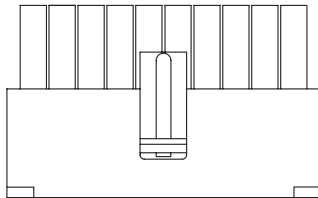

TERNIMAL / female
MF300TF - X - XX