



5.08mm Pitch



		
Rated Voltage	300V	250V
Rated Current	12A	
Insulation Withstand Voltage	AC 2000V / Min	
Insulation Resistance	≥ 500MΩ or More at DC500V	
Temperature Range	-40°C to +105°C	
Wire Range	28-14 AWG	2.5mm ²
Wire Strip Length	5.8 - 6.1mm	
Screw	M2.5	
Screw Torque	4.4 lbf.in	

Units: mm

- ① Housing: PA66(V0)
- ② Clamp: Bronze, Tin Plated
- ③ Screw: Steel, Zinc Plated
- ④ Cover: PA66(V0)
- ⑤ Block: Brass, Nickel Plated



2P

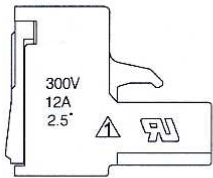
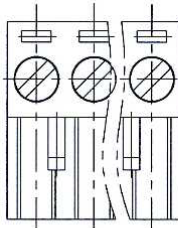

2P 5.08X(P-2)+1.50

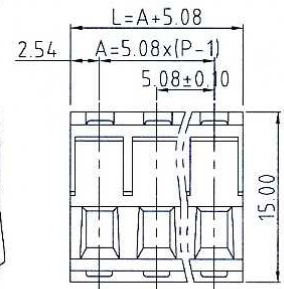
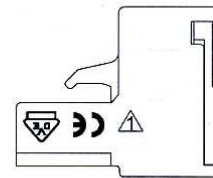
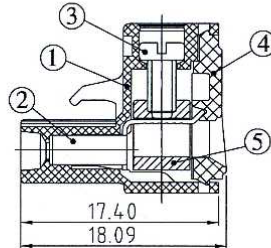
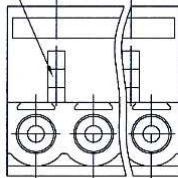

Part Numbering System:

PS-508V - XXP - XXX

① ② ③

① Series

② Number of Poles: 02, 03, 04, ..., 24

③ Insulator Color: GRN = Green, BLK = Black, ORG = Orange

# Pin	2	3	4	5	6	7	8	9	10	11	12	13
Dim L	10.16	15.24	20.32	25.4	30.48	35.56	40.64	45.72	50.8	55.88	60.96	66.04
Dim A	5.08	10.16	15.24	20.32	25.4	30.48	35.56	40.64	45.72	50.8	55.88	60.96
# Pin	14	15	16	17	18	19	20	21	22	23	24	
Dim L	71.12	76.2	81.28	86.36	91.44	96.52	101.6	106.68	111.76	116.84	121.92	
Dim A	66.04	71.12	76.2	81.28	86.36	91.44	96.52	101.6	106.68	111.76	116.84	