

Recommended P.C.Board SMD Layout

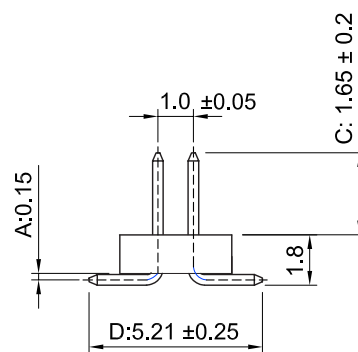
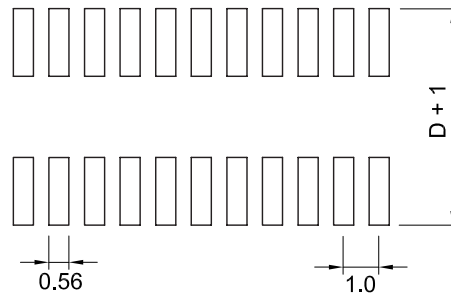

Specifications

- Current Rating: 1 Amp
- Insulator Resistance: 1000 Megohms min.
- Contact Resistance: 20 m ohms max.
- Dielectric Withstanding: AC 300V
- Operating Temperature : -40°C ~ +105°C
- Insulator Material: Polyester, UL 94V-0, Nylon-6T
- Contact Material: Brass
- Contact Plating: See Options / Standard Full Gold Flash

Part Numbering System

SDC100-H1.5 - XX - XX - XXXN

Series

No. of Pins

Pins Dimensions Code:

Code	A	C	D
02	0.15	1.91	5.21
03	0.15	1.65	5.21
XX	Custom: Please specify the A, C, & D dimensions, the code will be provided upon ordering.		

Contact Plating

Cap Option:

Nil = No Cap

P = Plastic

Insulator Material:

N = Nylon-6T

Packing Method:

Nil = Bulk

B = Tube

T = Tape & Reel

Example: SDC100-H1.5-12-02-GPBN

with 12pins, A = 0.15, C = 1.65, D = 5.21

* Contact Plating Option	Full Gold Plating	Gold Plated On Contact Area Tin Plated on Solder Area	Full Tin Plating
	G : Gold Flash G10: Gold 10u" G15: Gold 15u" G30: Gold 30u"	S: Gold Flash S10: Gold 10u" S15: Gold 15u" S30: Gold 30u"	T: Tin 100u"

General Tolerance	
X. ± 0.50	X.° ± 5°
.X ± 0.20	.X° ± 2°
.XX ± 0.10	.XX° ± 1°
Units : mm	