

FEATURES:

- Slide switch with smooth switching action
- LCP Nylon High Temp thermoplastic used.

MATERIAL:

- Cover: Stainless Steel
- Base: LCP High-Temp thermoplastic
Color: Black
- Contact: Alloy Copper
- Terminal: Brass
- Actuator: LCP High-Temp. Thermoplastic.
Color: Black

SPECIFICATION

MECHANICAL

- Operation Force: 200 ± 150 gf
- Operation Temperature Range: -10°C to $+60^{\circ}\text{C}$
- Storage Temperature Range: -20°C to $+70^{\circ}\text{C}$
- Electrical: 10 000 cycles
- Rating: 0.1A, 12 VDC

ELECTRICAL

- Electrical Life: 10 000 cycles
- Non-switching Rating: 100mA, 50 VDC
- Switching Rating: 25mA, 24 VDC
- Contact Resistance: 100m Ω max.
- Insulation Resistance: 100M Ω min. at 500VDC.
- Dielectric Strength: 500VAC/1 minute.
- Circuit: 1P2T, 2P2T

Packaging:

Part Number	Number Per Reel	Number Per Tube
SLS3595	900	50

SLS3595-22

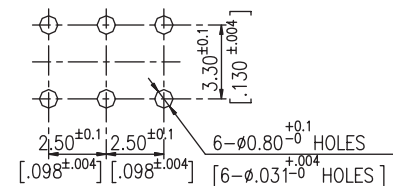
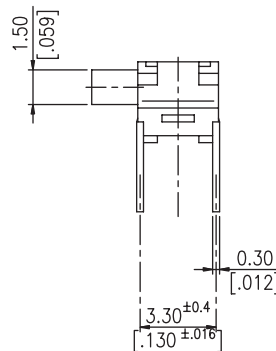
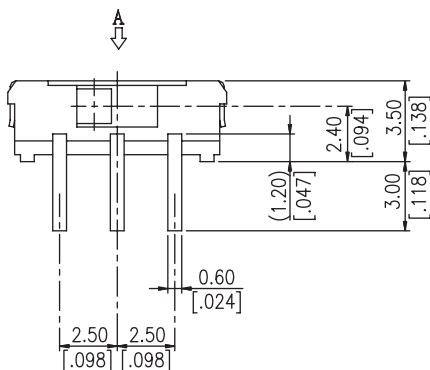
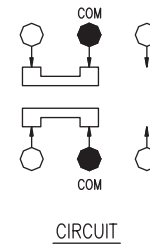
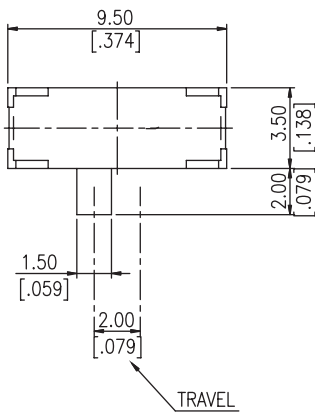

P.C.B. LAYOUT
(VIEW FROM THE DIRECTION A)

SLS3595-12

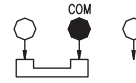
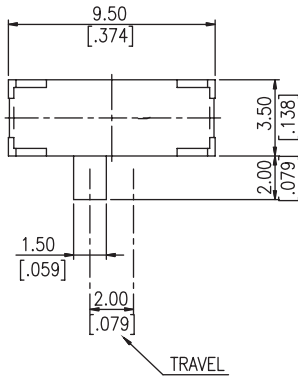

CIRCUIT

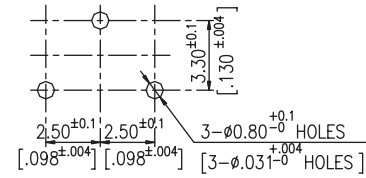
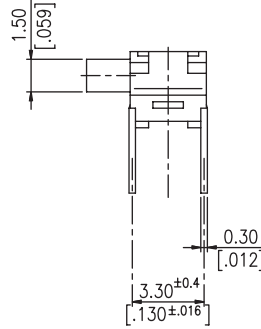
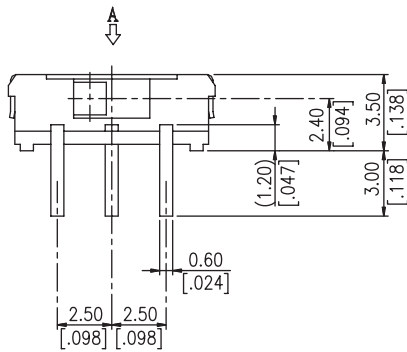

P.C.B. LAYOUT
(VIEW FROM THE DIRECTION A)

SLS3595C-12-P

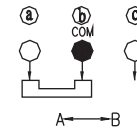
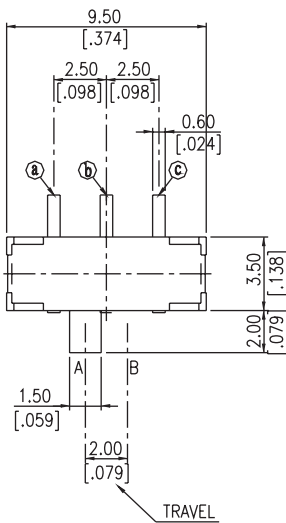

CIRCUIT

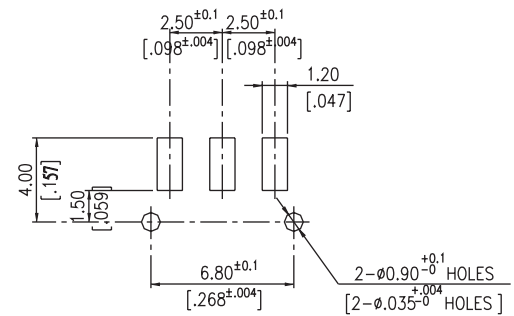
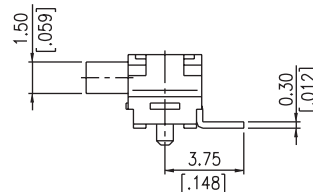
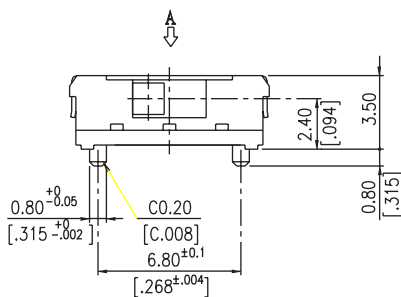

P.C.B. LAYOUT
(VIEW FROM THE DIRECTION A)

HOW TO ORDER:

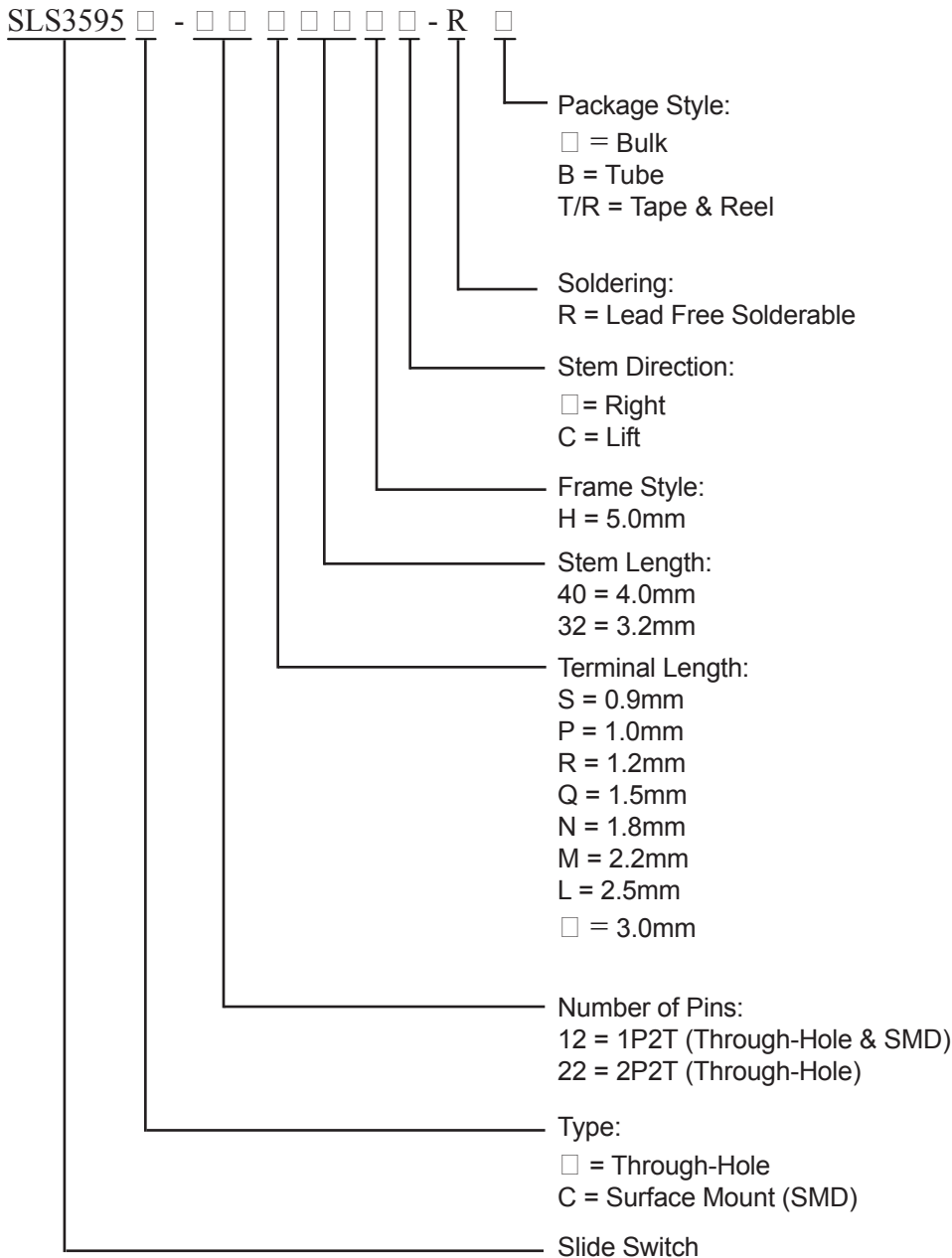

Soldering Process

▲ Hand Soldering : Use a soldering iron of 30 watts, controlled at 350°C approximately 5 seconds while applying solder.

▲ Reflow Soldering : When applying reflow soldering, the peak temperature or the reflow oven should be set to 260°C max.