

Recommended  
P.C. Board Hole Layout

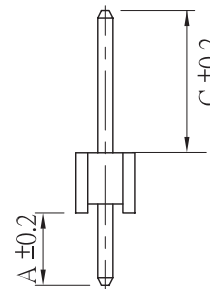
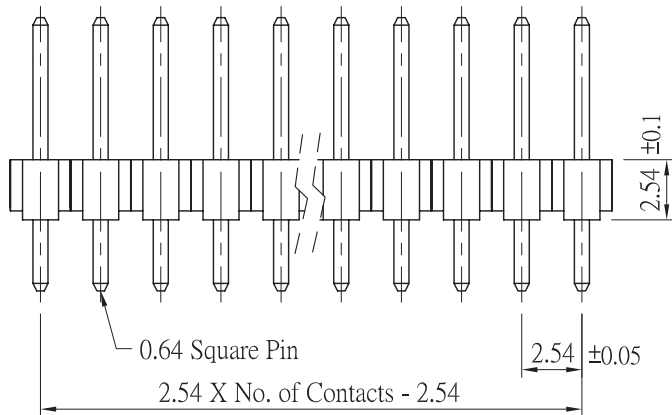
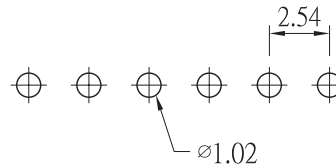

### Specifications

Current Rating: 3 Amps  
 Insulator Resistance: 1000 Megohms min.  
 Contact Resistance: 20 m ohms max.  
 Dielectric Withstanding: AC 600V  
 Operating Temperature: PBT: -55°C ~ +105°C  
 Nylon-6T: -55°C ~ +125°C

Contact Material: Brass  
 Contact Plated: See Option \ Standard = Full Gold Flash  
 Insulator Material: Polyester, UL 94V-0  
 P.B.T. (Standard) or Nylon-6T

**\*Standard Terminal Dimension: A= 3.00, C= 6.00**

### Part Numbering System

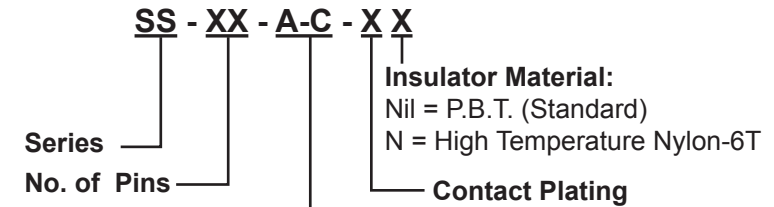

**Terminal Dimensions (mm)**  
 Nil = Standard Dimensions (A= 3.00, C= 6.00)  
 A = ... , C = ... for Custom Dimensions

**Standard Example: SS-10-G**  
 (with Standard Terminal Dimension)  
 A= 3.00, C= 6.00

**Custom Example: SS-10-2.54-8.13-G**  
 A = 2.54, C = 8.13

* Contact Plating Option	Full Gold Plating	Gold Plated on Contact Area Tin Plated on Solder Area	Full Tin Plating
	G : Gold Flash G10: Gold 10u" G15: Gold 15u" G30: Gold 30u"	S: Gold Flash S10: Gold 10u" S15: Gold 15u" S30: Gold 30u"	T: Tin 100u" TM200: Tin Matte 200u"

General Tolerance	
X. ± 0.50	X.° ± 5°
.X ± 0.20	.X° ± 2°
.XX ± 0.10	.XX° ± 1°
Units : mm	