

## VEH Series

### Features

- 4  $\phi$  ~ 10  $\phi$ , 105°C, 2,000 hours assured
- Vertical chip type miniaturized
- Low impedance capacitors
- Designed for surface mounting on high density PC board
- RoHS Compliance



Marking color: Black

### Specifications

Items	Performance																								
Category Temperature Range	-55°C ~ +105°C																								
Capacitance Tolerance	± 20% (at 120Hz, 20°C)																								
Leakage Current (at 20°C)	I = 0.01CV or 3 (μA) whichever is greater (after 2 minutes) Where, C = rated capacitance in μF V = rated DC working voltage in V																								
Tanδ (at 120Hz, 20°C)	<table border="1"> <thead> <tr> <th>Rated Voltage</th> <th>6.3</th> <th>10</th> <th>16</th> <th>25</th> <th>35</th> <th>50</th> </tr> </thead> <tbody> <tr> <td>Tanδ (max)</td> <td>0.30</td> <td>0.26</td> <td>0.22</td> <td>0.16</td> <td>0.13</td> <td>0.13</td> </tr> </tbody> </table>	Rated Voltage	6.3	10	16	25	35	50	Tanδ (max)	0.30	0.26	0.22	0.16	0.13	0.13										
Rated Voltage	6.3	10	16	25	35	50																			
Tanδ (max)	0.30	0.26	0.22	0.16	0.13	0.13																			
Low Temperature Characteristics (at 120Hz)	<p>Impedance ratio shall not exceed the values given in the table below.</p> <table border="1"> <thead> <tr> <th colspan="2">Rated Voltage</th> <th>6.3</th> <th>10</th> <th>16</th> <th>25</th> <th>35</th> <th>50</th> </tr> </thead> <tbody> <tr> <td>Impedance</td> <td>Z(-25°C)/Z(+20°C)</td> <td>4</td> <td>3</td> <td>2</td> <td>2</td> <td>2</td> <td>2</td> </tr> <tr> <td>Ratio</td> <td>Z(-55°C)/Z(+20°C)</td> <td>10</td> <td>7</td> <td>5</td> <td>3</td> <td>3</td> <td>3</td> </tr> </tbody> </table>	Rated Voltage		6.3	10	16	25	35	50	Impedance	Z(-25°C)/Z(+20°C)	4	3	2	2	2	2	Ratio	Z(-55°C)/Z(+20°C)	10	7	5	3	3	3
Rated Voltage		6.3	10	16	25	35	50																		
Impedance	Z(-25°C)/Z(+20°C)	4	3	2	2	2	2																		
Ratio	Z(-55°C)/Z(+20°C)	10	7	5	3	3	3																		
Endurance	<table border="1"> <thead> <tr> <th>Test Time</th> <th>2,000 Hrs</th> </tr> </thead> <tbody> <tr> <td>Capacitance Change</td> <td>Within ±25% of initial value for <math>\phi D \leq 6.3</math> mm; Within ±20% of initial value for <math>\phi D \geq 8</math> mm</td> </tr> <tr> <td>Tanδ</td> <td>Less than 200% of specified value</td> </tr> <tr> <td>Leakage Current</td> <td>Within specified value</td> </tr> </tbody> </table> <p>* The above Specifications shall be satisfied when the capacitors are restored to 20°C after the rated voltage applied for 2,000 hours at 105°C.</p>	Test Time	2,000 Hrs	Capacitance Change	Within ±25% of initial value for $\phi D \leq 6.3$ mm; Within ±20% of initial value for $\phi D \geq 8$ mm	Tanδ	Less than 200% of specified value	Leakage Current	Within specified value																
Test Time	2,000 Hrs																								
Capacitance Change	Within ±25% of initial value for $\phi D \leq 6.3$ mm; Within ±20% of initial value for $\phi D \geq 8$ mm																								
Tanδ	Less than 200% of specified value																								
Leakage Current	Within specified value																								
Shelf Life Test	<table border="1"> <thead> <tr> <th>Test Time</th> <th>1,000 Hrs</th> </tr> </thead> <tbody> <tr> <td>Capacitance Change</td> <td>Within ±25% of initial value for <math>\phi D \leq 6.3</math> mm; Within ±20% of initial value for <math>\phi D \geq 8</math> mm</td> </tr> <tr> <td>Tanδ</td> <td>Less than 200% of specified value</td> </tr> <tr> <td>Leakage Current</td> <td>Within specified value</td> </tr> </tbody> </table> <p>* The above Specifications shall be satisfied when the capacitors are restored to 20°C after exposing them for 1,000 hours at 105°C without voltage applied.</p>	Test Time	1,000 Hrs	Capacitance Change	Within ±25% of initial value for $\phi D \leq 6.3$ mm; Within ±20% of initial value for $\phi D \geq 8$ mm	Tanδ	Less than 200% of specified value	Leakage Current	Within specified value																
Test Time	1,000 Hrs																								
Capacitance Change	Within ±25% of initial value for $\phi D \leq 6.3$ mm; Within ±20% of initial value for $\phi D \geq 8$ mm																								
Tanδ	Less than 200% of specified value																								
Leakage Current	Within specified value																								
Ripple Current & Frequency Multipliers	<table border="1"> <thead> <tr> <th>Frequency (Hz)</th> <th>50, 60</th> <th>120</th> <th>1k</th> <th>10k up</th> </tr> </thead> <tbody> <tr> <td>Multiplier</td> <td>0.64</td> <td>0.8</td> <td>0.93</td> <td>1.0</td> </tr> </tbody> </table>	Frequency (Hz)	50, 60	120	1k	10k up	Multiplier	0.64	0.8	0.93	1.0														
Frequency (Hz)	50, 60	120	1k	10k up																					
Multiplier	0.64	0.8	0.93	1.0																					

### Diagram of Dimensions

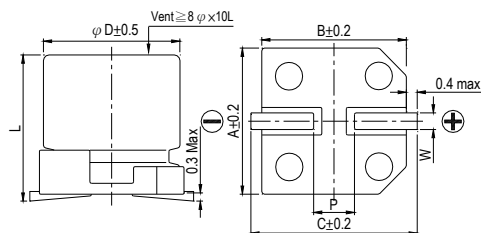

### Lead Spacing and Diameter

Unit: mm

$\phi D$	L	A	B	C	W	P ± 0.2
4	5.7 ± 0.3	4.3	4.3	5.1	0.5 ~ 0.8	1.0
5	5.7 ± 0.3	5.3	5.3	5.9	0.5 ~ 0.8	1.5
6.3	5.7 ± 0.3	6.6	6.6	7.2	0.5 ~ 0.8	2.0
8	10 ± 0.5	8.4	8.4	9.0	0.7 ~ 1.1	3.1
10	10 ± 0.5	10.4	10.4	11.0	0.7 ~ 1.3	4.7

### Marking

$\phi D \leq 6.3$ mm

$\phi D = 8 \sim 10$  mm

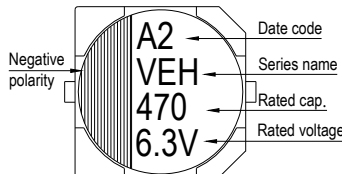
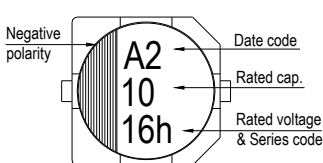



Dimension:  $\phi D \times L$ (mm)  
 Ripple Current: mA/rms at 100k Hz, 105°C  
 Impedance:  $\Omega$ / at 100k Hz, 20°C

**Dimension & Permissible Ripple Current**

$\mu F$	V. DC Contents	6.3V (0J)			10V (1A)			16V (1C)			25V (1E)			35V (1V)			50V (1H)		
		$\phi D \times L$	Imp.	mA	$\phi D \times L$	Imp.	mA	$\phi D \times L$	Imp.	mA	$\phi D \times L$	Imp.	mA	$\phi D \times L$	Imp.	mA	$\phi D \times L$	Imp.	mA
3.3	3R3																4×5.7	5.0	30
4.7	4R7										4×5.7	3.2	65	4×5.7	3.2	65	4×5.7	5.0	30
10	100							4×5.7	3.2	65	5×5.7	1.5	110	5×5.7	1.5	110	5×5.7	3.0	50
22	220				4×5.7	3.2	65	5×5.7	1.5	110	6.3×5.7	0.85	170	6.3×5.7	0.85	170	6.3×5.7	2.0	70
33	330	4×5.7	3.2	65	5×5.7	1.5	110	6.3×5.7	0.85	170	6.3×5.7	0.85	170	6.3×5.7	0.85	170	8×10	0.6	300
47	470	5×5.7	1.5	110	6.3×5.7	0.85	170	6.3×5.7	0.85	170	6.3×5.7	0.85	170	8×10	0.45	450	8×10	0.6	300
100	101	6.3×5.7	0.85	170	6.3×5.7	0.85	170	8×10	0.45	450	8×10	0.45	450	8×10	0.45	450	8×10	0.6	300
150	151	6.3×5.7	0.85	170	6.3×5.7	0.85	170	8×10	0.45	450	8×10	0.45	450	8×10	0.45	450	10×10	0.3	500
220	221	6.3×5.7	0.85	170	8×10	0.45	450	8×10	0.45	450	8×10	0.45	450	10×10	0.25	670			
330	331	8×10	0.45	450	8×10	0.45	450	8×10	0.45	450	10×10	0.25	670						
470	471	8×10	0.45	450	8×10	0.45	450	10×10	0.25	670									
820	821	10×10	0.25	670	10×10	0.25	670												
1,000	102	10×10	0.25	670															

**Part Numbering System**

VEH series	470 $\mu F$	$\pm 20\%$	6.3V	Carrier Tape	8 $\phi \times 10L$	Pb-free and PET coating case
<b>VEH</b>	<b>471</b>	<b>M</b>	<b>0J</b>	<b>TR</b>	<b>-</b>	<b>0810</b>
Series name	Capacitance	Capacitance Tolerance	Rated Voltage	Package Type	Terminal Type	Case size
						Lead Wire and Coating Type

Note: For more details, please refer to "Part Numbering System (SMD Type)" on page 12.