

Recommended  
P.C. Board Hole Layout

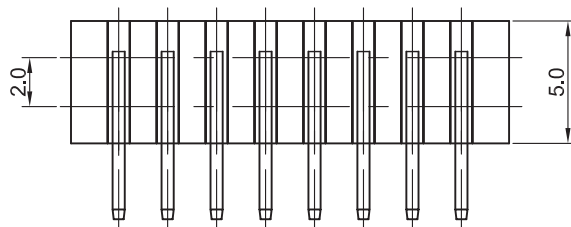
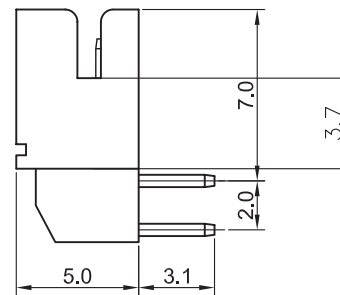
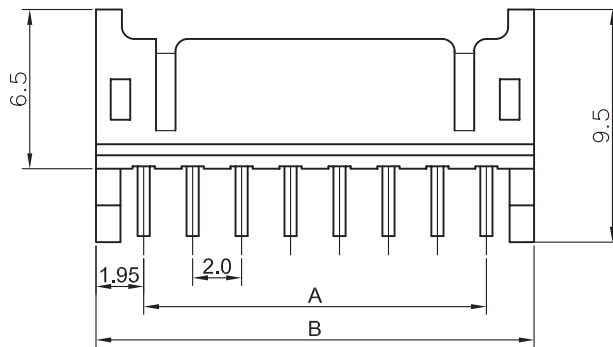
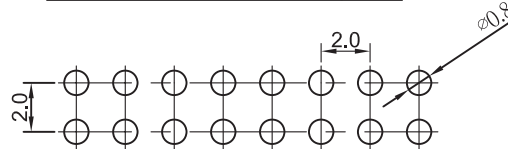

### Specifications

- Current Rating: 5AAC, DC
- Voltage Rating: 250V AC, DC
- Withstand Voltage: 1500V AC / min
- Insulation Resistance: 1000M ohms / min
- Temperature Range: -25°C ~ +85°C
- Wafer: High Temp. Plastic Nylon 46 UL94V-2
- Pin: High Strength Brass with Tin over Nickel Plated

### Part Numbering System

**W200-D1-RD - XX T**

- Series
- # of Contact  
06 ~ 32
- Contact Plating  
T = Tin

Contacts	Dimension mm	
	A	B
6	4.0	8.0
8	6.0	10.0
10	8.0	12.0
12	10.0	14.0
14	12.0	16.0
16	14.0	18.0
18	16.0	20.0
20	18.0	22.0
22	20.0	24.0
24	22.0	26.0
26	24.0	28.0
28	26.0	30.0
30	28.0	32.0
32	30.0	34.0

General Tolerance	
X. ± 0.50	X.° ± 5°
.X ± 0.20	.X° ± 2°
.XX ± 0.10	.XX° ± 1°
Units : mm	

### Recommended P.C. Board Hole Layout

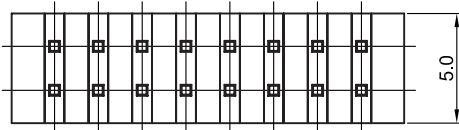
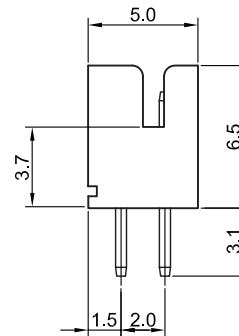
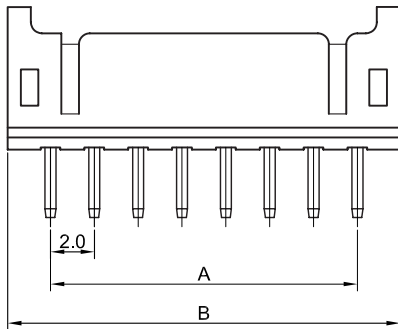
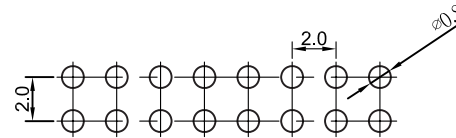
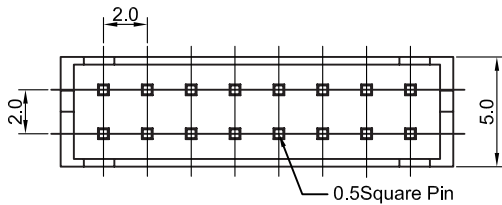

### Specifications

Current Rating: 5AAC, DC  
Voltage Rating: 250V AC, DC  
Withstand Voltage: 1500V AC / min  
Insulation Resistance: 1000M ohms / min  
Temperature Range: -25°C ~ +85°C  
Wafer: High Temp. Plastic Nylon 46 UL94V-2  
Pin: High Strength Brass with Tin over Nickel Plated

### Part Numbering System

**W200-D1-SD - XX T**

Series

# of Contact  
06 ~ 32

Contact Plating  
T = Tin

Contacts	Dimension mm	
	A	B
6	4.0	8.0
8	6.0	10.0
10	8.0	12.0
12	10.0	14.0
14	12.0	16.0
16	14.0	18.0
18	16.0	20.0
20	18.0	22.0
22	20.0	24.0
24	22.0	26.0
26	24.0	28.0
28	26.0	30.0
30	28.0	32.0
32	30.0	34.0

General Tolerance	
X. ± 0.50	X.° ± 5°
.X ± 0.20	.X° ± 2°
.XX ± 0.10	.XX° ± 1°
Units : mm	

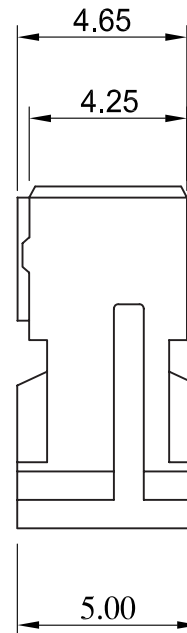
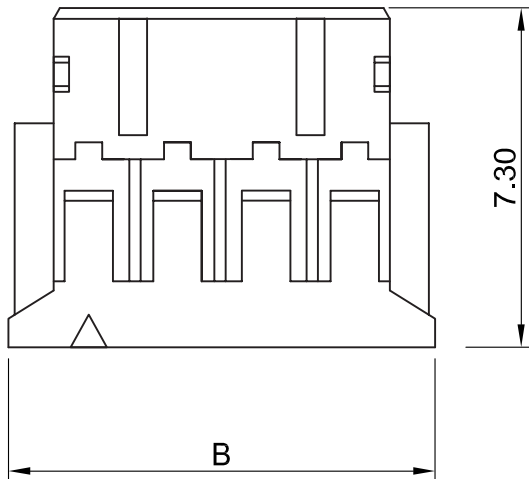
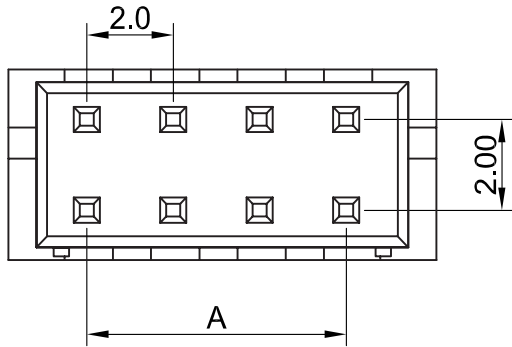

General Tolerance	
X. ± 0.50	X.° ± 5°
.X ± 0.20	.X° ± 2°
.XX ± 0.10	.XX° ± 1°
Units : mm	

## Specifications

Current Rating: 2AAC, DC  
 Voltage Rating: 250V AC, DC  
 Withstand Voltage: 800V AC / min  
 Insulation Resistance: 1000M ohms min  
 Contact Resistance: 20m ohms max.  
 Temperature Range: -25°C ~ +85°C  
 Material: Nylon 66, UL94V-0  
 \*Housing Mates with: Wafer: W200-D1,  
 Terminals: W200T-D

## Part Numbering System

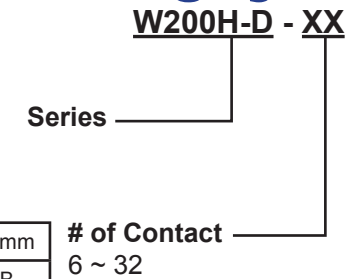

Contacts	Dimension mm	
	A	B
06	4.00	7.90
08	6.00	9.90
10	8.00	11.90
12	10.00	13.90
14	12.00	15.90
16	14.00	17.90
18	16.00	19.90
20	18.00	21.90
22	20.00	23.90
24	22.00	25.90
26	24.00	27.90
28	26.00	29.90
30	28.00	31.90
32	30.00	33.90

### Specifications

Current Rating: 1AAC, DC  
 Voltage Rating: 100V AC / max  
 Withstand Voltage: 800V AC / min  
 Insulation Resistance: 1000 ohms / min  
 Contact Resistance: 20 ohms max.  
 Temperature Range: -25°C ~ +85°C  
 Terminal Material: Phosphor Bronze / Tin-plated  
 Terminal Thickness: 0.2mm  
 Wire Range: AWG #22-28  
 Packaging: 10,000pcs / Reel  
 \*For Housing W200H-D Series

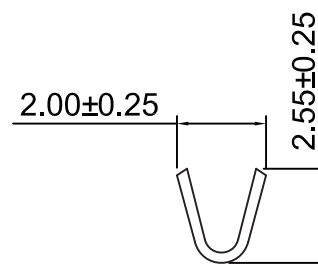
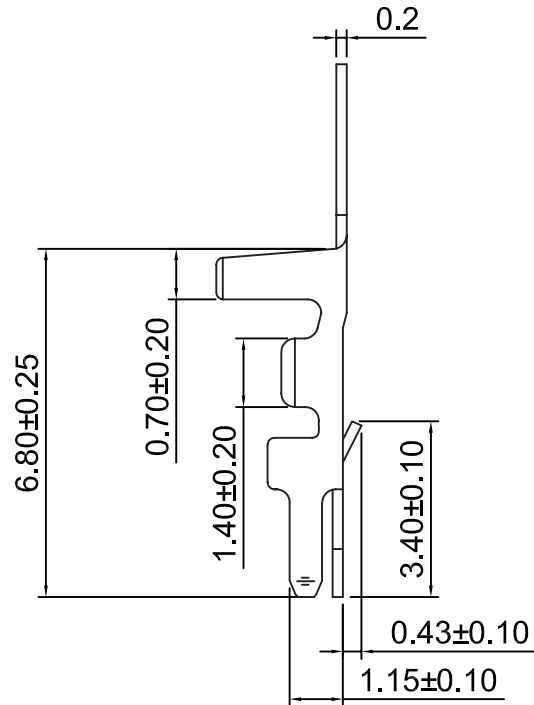
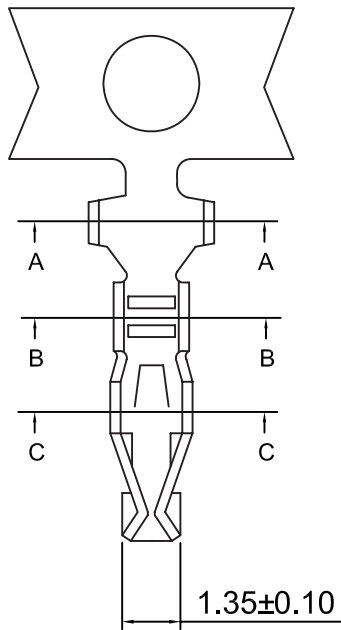

A-A SECTION

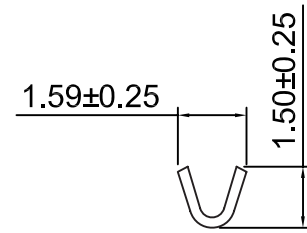

B-B SECTION

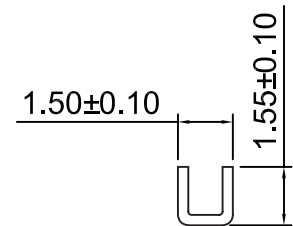

C-C SECTION

### Part Numbering System

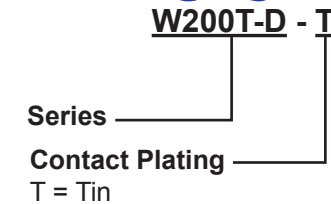

General Tolerance	
X. ± 0.50	X.° ± 5°
.X ± 0.20	.X° ± 2°
.XX ± 0.10	.XX° ± 1°
Units : mm	