

Recommended
P.C. Board Hole Layout

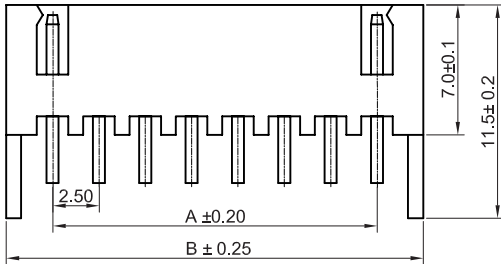

3Pin ~ 20 Pin

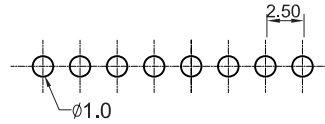
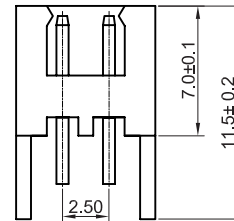
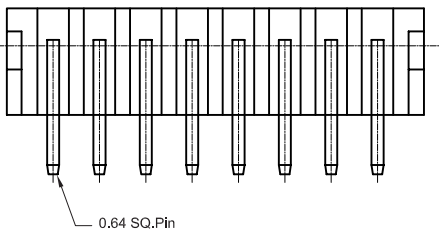

2 Pin

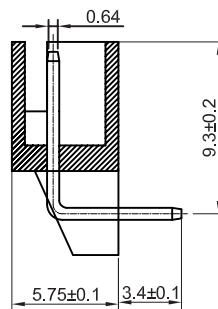

Standard

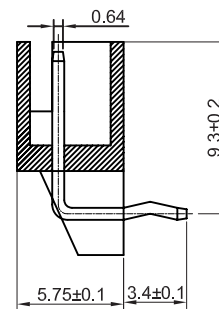

Kinked

Specifications

Current Rating: 3AAC, DC
Voltage Rating: 250V AC Maximum
Insulation Resistance: 1000 Mohms Min.
Contact Resistance: 10 mohms max.
Temperature Range: -25°C ~ +85°C
Wafer: Nylon 66, UL94V-0
Terminal Material: Brass / Tin-Plated

Part Numbering System

W250-J1-RS - XX T X

Series

of Contact
02 ~ 20

Contact Plating
T = Tin

Kink Option
Nil = Not Kinked
K = Kinked

Contacts	Dimension mm	
	A	B
2	2.50	7.50
3	5.00	10.0
4	7.50	12.50
5	10.0	15.00
6	12.50	17.50
7	15.00	20.00
8	17.50	22.50
9	20.00	25.00
10	22.50	27.50
11	25.00	30.00
12	27.50	32.50
13	30.00	35.00
14	32.50	37.50
15	35.00	40.00
16	37.50	42.50
17	40.00	45.00
18	42.50	47.50
19	45.00	50.00
20	47.50	52.50

General Tolerance	
X. ± 0.50	X.° ± 5°
.X ± 0.20	.X° ± 2°
.XX ± 0.10	.XX° ± 1°
Units : mm	

Rev. No. : PE11

Specifications

Current Rating: 3AAC, DC
Voltage Rating: 250V AC Maximum
Insulation Resistance: 1000M ohms Min.
Contact Resistance: 10m ohms max.
Temperature Range: -25°C ~ +85°C
Wafer: Nylon 66, UL94V-0
Terminal Material: Brass / Tin-Plated

Recommended P.C. Board Hole Layout

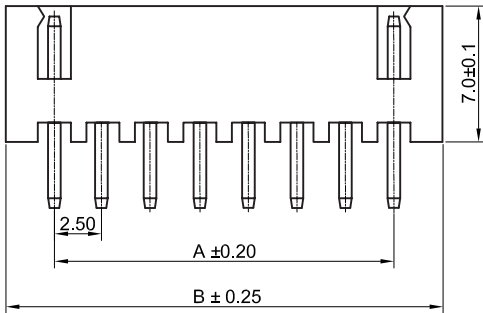
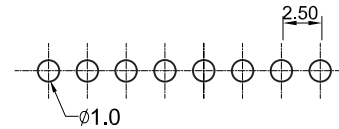
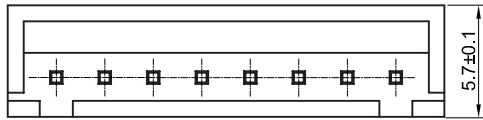

3Pin ~ 20 Pin

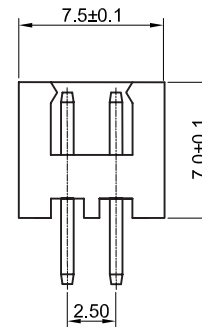

2 Pin

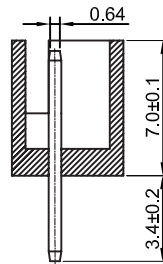

Standard

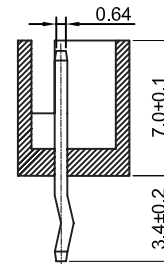

Kinked

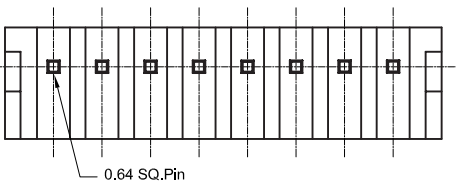

Part Numbering System

Contacts	Dimension mm	
	A	B
2	2.50	7.50
3	5.00	10.0
4	7.50	12.50
5	10.0	15.00
6	12.50	17.50
7	15.00	20.00
8	17.50	22.50
9	20.00	25.00
10	22.50	27.50
11	25.00	30.00
12	27.50	32.50
13	30.00	35.00
14	32.50	37.50
15	35.00	40.00
16	37.50	42.50
17	40.00	45.00
18	42.50	47.50
19	45.00	50.00
20	47.50	52.50

W250-J1-SS - XX T X

Series

of Contact
02 ~ 20

Contact Plating
T = Tin

Kink Option
Nil = Not Kinked
K = Kinked

General Tolerance	
X. ± 0.50	X.° ± 5°
.X ± 0.20	.X° ± 2°
.XX ± 0.10	.XX° ± 1°
Units : mm	

Specifications

Current Rating: 3A AC, DC
 Voltage Rating: 250V AC, DC
 Operating Temperature: -25°C ~ +85°C
 Insulation Resistance: 1000M ohms min.
 Withstanding Voltage: 1000V AC / minute
 Insulator Material: Nylon 66, UL94V-0
 *Housing mates with: Wafer: W250-J1,
 Terminal: W250T-J1

Part Numbering System

W250H-J1 - XX

Series

of Holes
02 ~ 20

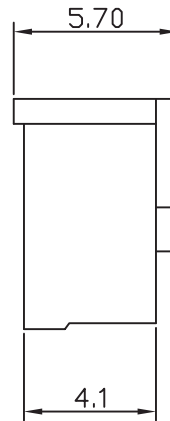
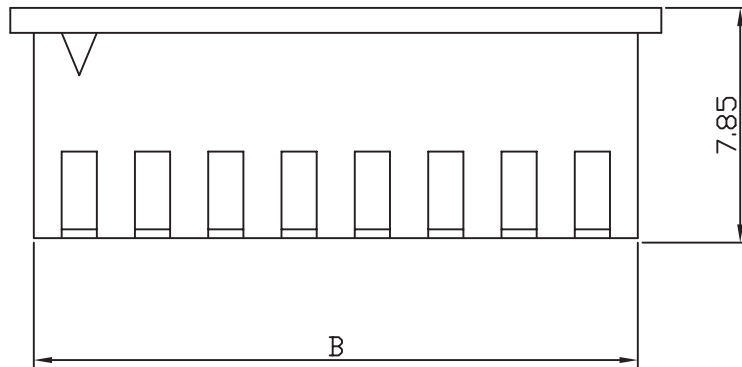
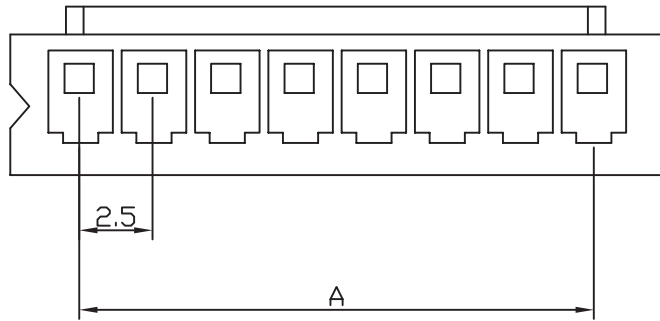

Contacts	Dimension mm	
	A	B
2	2.50	5.70
3	5.00	8.20
4	7.50	10.70
5	10.00	13.20
6	12.50	15.70
7	15.00	18.20
8	17.50	20.70
9	20.00	23.20
10	22.50	25.70
11	25.00	28.20
12	27.50	30.70
13	30.00	33.20
14	32.50	35.70
15	35.00	38.20
16	37.50	40.70
20	47.50	50.70

General Tolerance	
X. ± 0.50	X.° ± 5°
.X ± 0.20	.X° ± 2°
.XX ± 0.10	.XX° ± 1°
Units : mm	

